

Edificio Convenciones. Planta -1  
*Hotel Building, Lower Level*

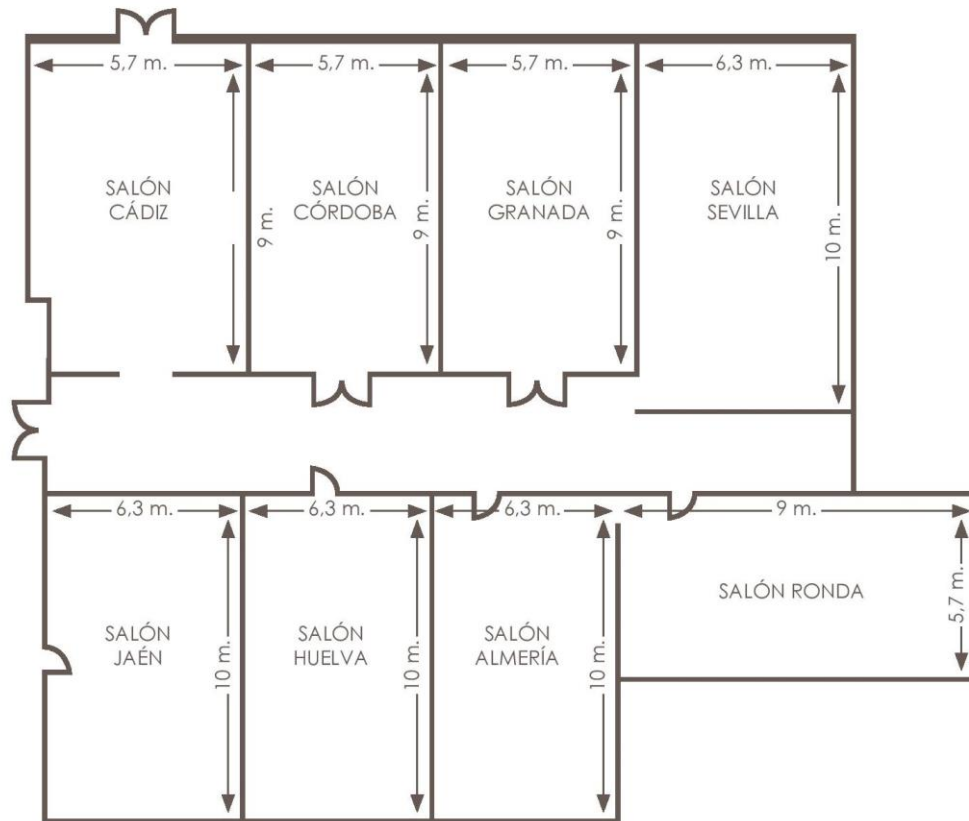

Welcome to the Melia Avenida America Hotel & Convention Center.

*We are happy to provide you with our detailed floor plans and please keep in mind the following:*

- All Meeting Rooms with natural daylight
- None of our Meeting Rooms have columns
- Meeting Rooms located on the first, second, third and fourth floor of our Convention Center have 3m ceiling height
- WIFI Complimentary throughout our Convention Center
- All our meeting rooms, except: Tech Room, Mallorca, Menorca & Ibiza include technical floors

| SALONES        | PLANTA | M <sup>2</sup> | ALTURA | DIM. : LxA | U  | ESCUELA   | TEATRO  | IMPERIAL  | CABARET |
|----------------|--------|----------------|--------|------------|----|-----------|---------|-----------|---------|
| MEETING ROOMS  | FLOOR  | SQM            | HEIGHT | DIMENSIONS | U  | CLASSROOM | THEATRE | BOARDROOM | CABARET |
| <b>CÁDIZ</b>   | - 1    | 51.87          | 2,30   | 9x5,7      | 16 | 25        | 30      | 18        | 18      |
| <b>GRANADA</b> | - 1    | 49,05          | 2,58   | 9x5,7      | 16 | 25        | 30      | 18        | 18      |
| <b>CÓRDOBA</b> | - 1    | 48,59          | 2,58   | 9x5,7      | 16 | 25        | 30      | 18        | 18      |
| <b>SEVILLA</b> | - 1    | 61,54          | 2,58   | 10x6,3     | 16 | 25        | 30      | 18        | 18      |
| <b>RONDA</b>   | - 1    | 46,71          | 2,89   | 9x5,7      | 16 | 25        | 30      | 18        | 18      |
| <b>JAÉN</b>    | - 1    | 47,70          | 2,87   | 10x6,3     | 16 | 25        | 30      | 18        | 18      |
| <b>HUELVA</b>  | - 1    | 47,46          | 2,89   | 10x6,3     | 16 | 25        | 30      | 18        | 18      |
| <b>ALMERÍA</b> | - 1    | 48,30          | 2,89   | 10x6,3     | 16 | 25        | 30      | 18        | 18      |

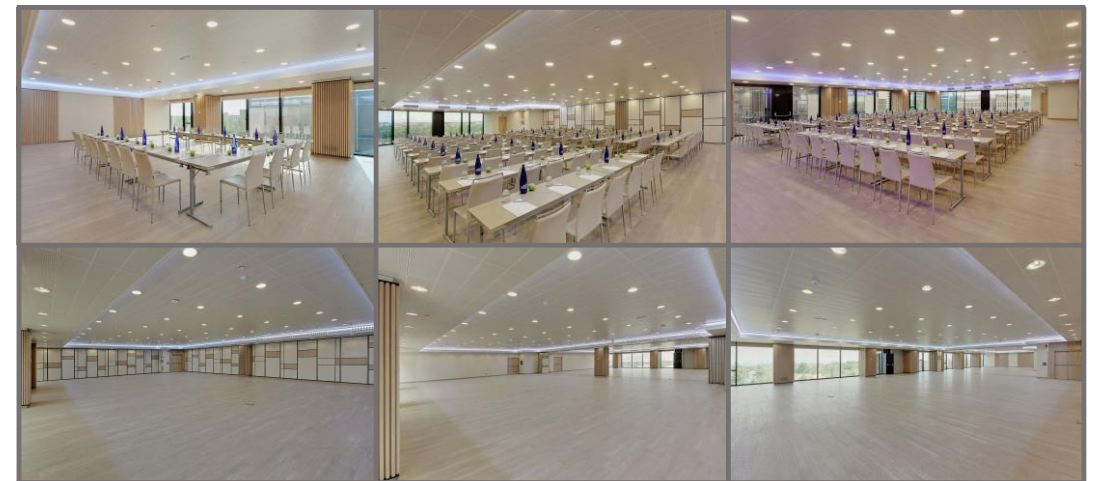

## Edificio Convenciones. Planta 0 Convention Center, Ground Floor

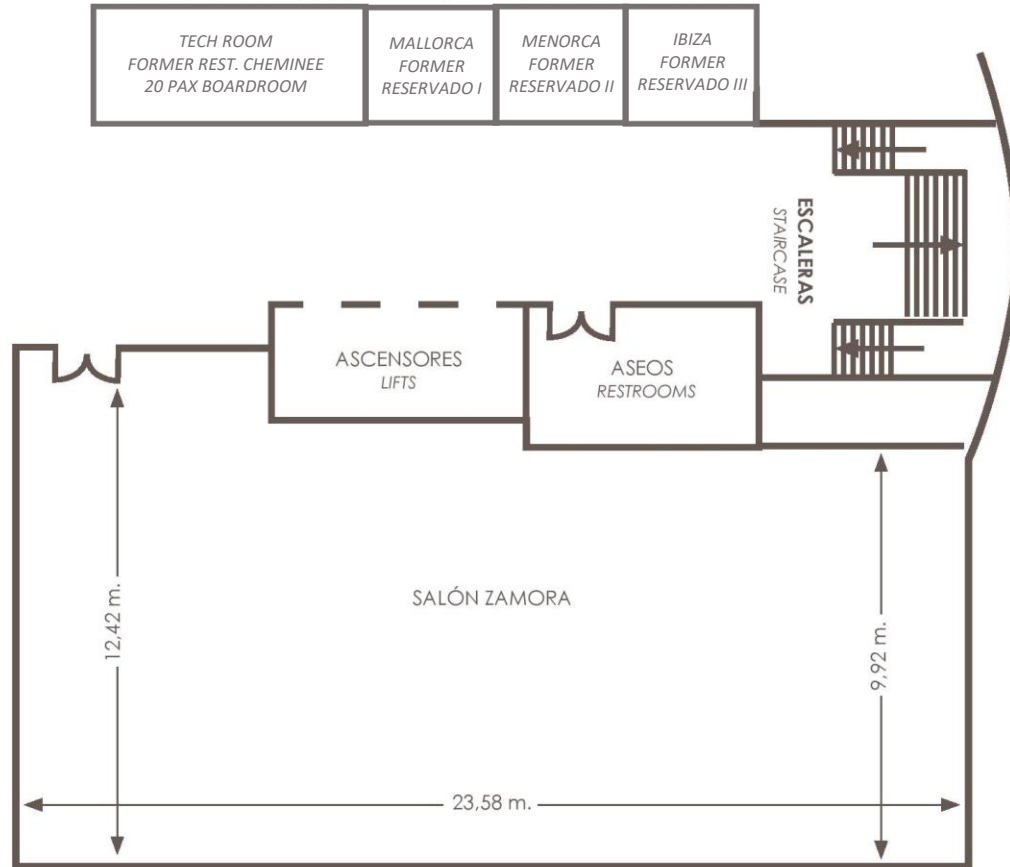

| SALONES        | PLANTA | M <sup>2</sup> | ALTURA | COCKTAIL | BANQUETE | BUFFET |
|----------------|--------|----------------|--------|----------|----------|--------|
| MEETING ROOMS  | FLOOR  | SQM            | HEIGHT | COCKTAIL | BANQUETE | BUFFET |
| ZAMORA         | 0      | 246,20         | 2,70   | -        | 170      | 170    |
| *RESERVADO I   | 0      | 40             | 2,70   | -        | 26       | -      |
| *RESERVADO II  | 0      | 40             | 2,70   | -        | 22       | -      |
| *RESERVADO III | 0      | 40             | 2,70   | -        | 30       | -      |

\*En restaurante La Cheminée/in La Cheminée Restaurant

## Edificio Convenciones. Planta 1 Convention Center, 1st Floor

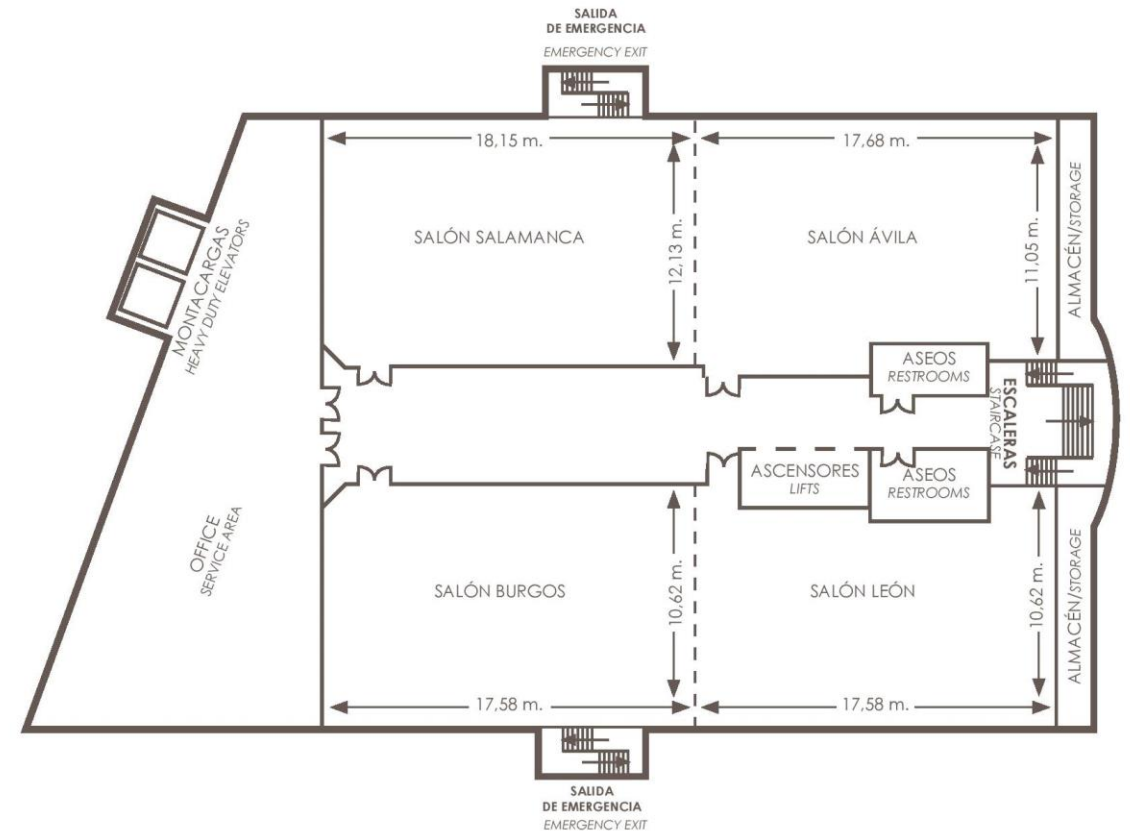

| SALONES         | PLANTA | M <sup>2</sup> | ALTURA | DIM.: LxA  | U   | ESCUELA    | TEATRO  | IMPERIAL   | BANQ. | COCKTAIL | CABARET |
|-----------------|--------|----------------|--------|------------|-----|------------|---------|------------|-------|----------|---------|
| MEETING ROOMS   | FLOOR  | SQM            | HEIGHT | DIMENSIONS | U   | CLASS-ROOM | THEATRE | BOARD-ROOM | BANQ. | COCKTAIL | CABARET |
| BURGOS          | 1ª     | 208,47         | 2,98   | 19x12m.    | 50  | 120        | 230     | 50         | 150   | 200      | 95      |
| LEÓN            | 1ª     | 184,25         | 2,98   | 19x11m.    | 40  | 100        | 150     | 40         | 120   | 150      | 85      |
| BURGOS + LEÓN   | 1ª     | 392,72         | 2,98   | 35x11m.    | 110 | 250        | 380     | 95         | 280   | 400      | 200     |
| SALAMANCA       | 1ª     | 215,54         | 2,98   | 19x12m.    | 50  | 120        | 230     | 50         | 150   | 200      | 95      |
| ÁVILA           | 1ª     | 200,27         | 2,98   | 19x11m.    | 40  | 100        | 150     | 40         | 120   | 150      | 85      |
| SALAMANCA+ÁVILA | 1ª     | 415,81         | 2,98   | 35x11m.    | 110 | 250        | 380     | 95         | 280   | 400      | 200     |

## Edificio Convenciones. Planta 2 Convention Center, 2nd Floor

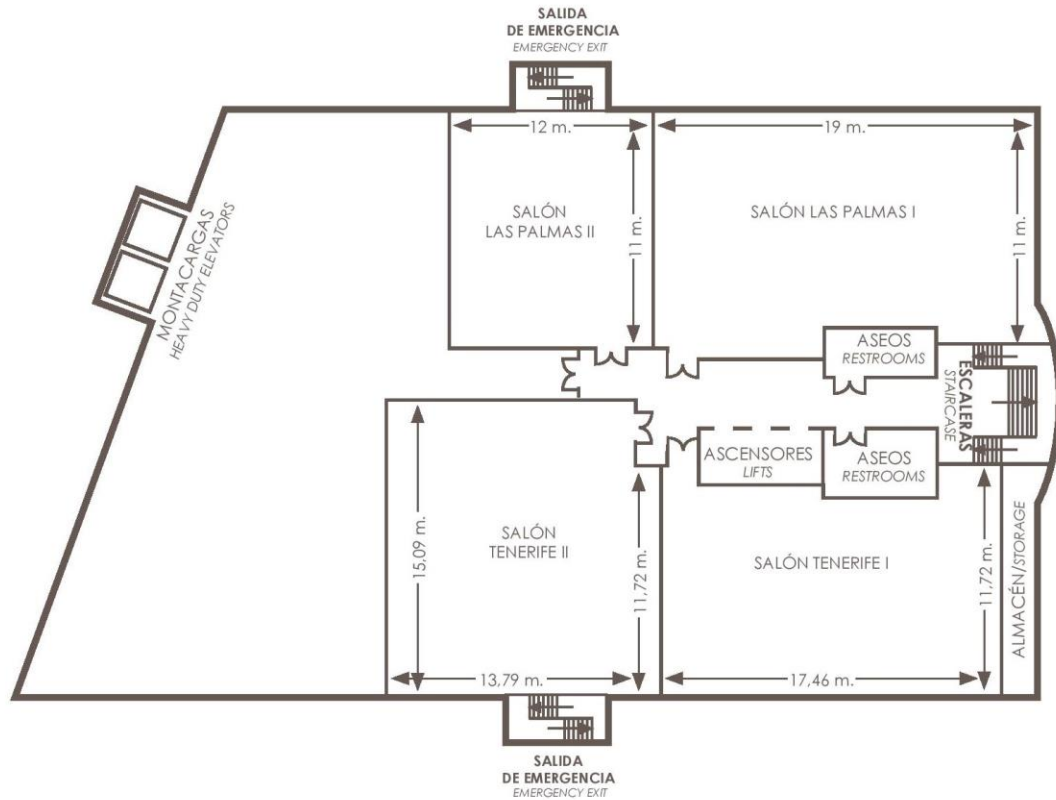

| SALONES<br>MEETING ROOMS | PLANTA<br>FLOOR | M <sup>2</sup><br>SQM | ALTURA<br>HEIGHT | DIM. : LxA<br>DIMENSIONS | U   | ESCUELA<br>CLASS-ROOM | TEATRO<br>THEATRE | IMPERIAL<br>BOARD-ROOM | BANQ.<br>BANQ. | COCKTAIL<br>COCKTAIL | CABARET<br>CABARET |
|--------------------------|-----------------|-----------------------|------------------|--------------------------|-----|-----------------------|-------------------|------------------------|----------------|----------------------|--------------------|
| TENERIFE I               | 2ª              | 185.10                | 2.98             | 19x12                    | 50  | 90                    | 160               | 40                     | 120            | 200                  | 85                 |
| TENERIFE II              | 2ª              | 200.33                | 2.98             | 14.50x15                 | 40  | 90                    | 160               | 40                     | 120            | 200                  | 85                 |
| TENERIFE I + II          | 2ª              | 385.43                | 2.98             | 31X12                    | 120 | 220                   | 380               | 80                     | 250            | 400                  | 185                |
| LAS PALMAS II            | 2ª              | 117.54                | 2.98             | 12x11                    | 30  | 50                    | 80                | 30                     | 80             | 100                  | 50                 |
| LAS PALMAS I             | 2ª              | 216.91                | 2.98             | 19x11                    | 50  | 85                    | 160               | 40                     | 150            | 200                  | 70                 |
| LAS PALMAS               | 2ª              | 334.45                | 2.98             | 33x11                    | 100 | 175                   | 280               | 80                     | 220            | 350                  | 150                |

## Edificio Convenciones. Planta 3 Convention Center, 3rd Floor

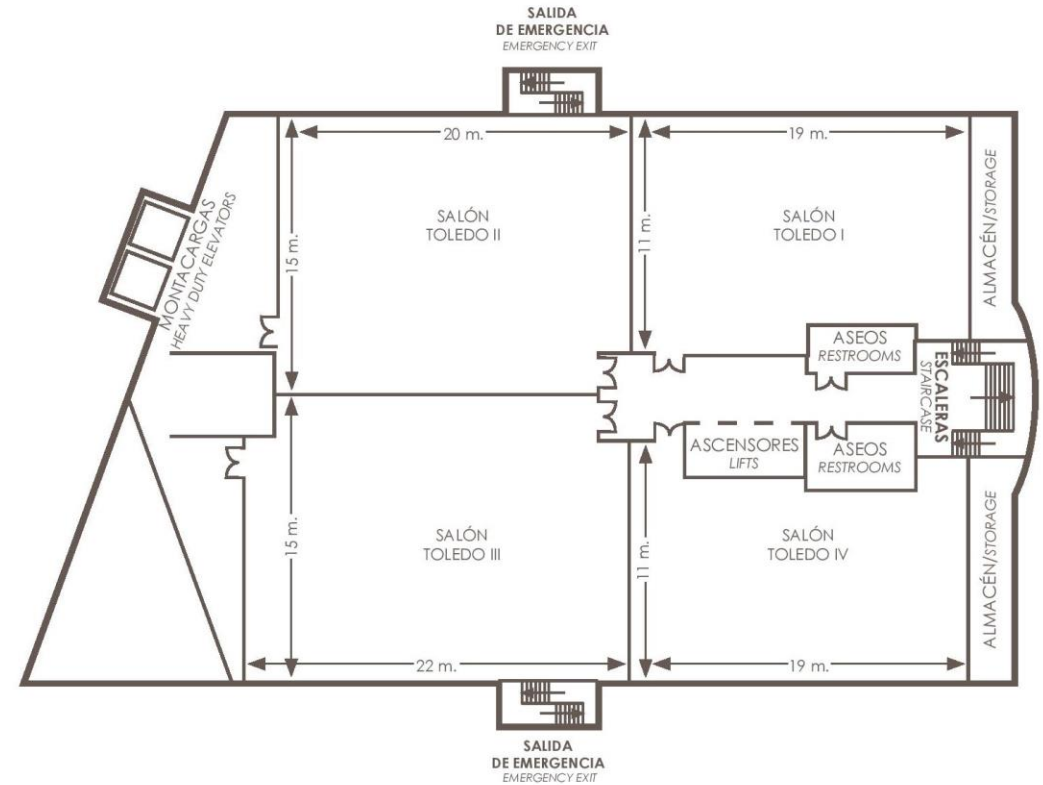

| SALONES<br>MEETING ROOMS | PLANTA<br>FLOOR | M <sup>2</sup><br>SQM | ALTURA<br>HEIGHT | DIM. : LxA<br>DIMENSIONS | U   | ESCUELA<br>CLASS-ROOM | TEATRO<br>THEATRE | IMPERIAL<br>BOARD-ROOM | BANQ.<br>BANQ. | COCKTAIL<br>COCKTAIL | CABARET<br>CABARET |
|--------------------------|-----------------|-----------------------|------------------|--------------------------|-----|-----------------------|-------------------|------------------------|----------------|----------------------|--------------------|
| TOLEDO I                 | 3ª              | 197.73                | 2.68             | 19x11                    | 50  | 100                   | 175               | 50                     | 100            | 150                  | 85                 |
| TOLEDO II                | 3ª              | 276.96                | 2.68             | 20x15                    | 60  | 170                   | 300               | 50                     | 200            | 300                  | 140                |
| TOLEDO III               | 3ª              | 301.54                | 2.68             | 22x15                    | 60  | 170                   | 30                | 50                     | 200            | 300                  | 140                |
| TOLEDO IV                | 3ª              | 185.06                | 2.68             | 19x11                    | 50  | 100                   | 175               | 50                     | 100            | 150                  | 85                 |
| TOLEDO I + II            | 3ª              | 474.69                | 2.68             | 39x14                    | 120 | 300                   | 500               | 110                    | 310            | 550                  | 260                |
| TOLEDO III + IV          | 3ª              | 486.60                | 2.68             | 41x13                    | 120 | 300                   | 500               | 100                    | 310            | 550                  | 260                |
| TOLEDO I + II + III + IV | 3ª              | 961.29                | 2.68             | 40x27                    | -   | -                     | -                 | -                      | 600            | 800                  | -                  |

Edificio Convenciones. Planta 4  
Convention Center, 4th Floor

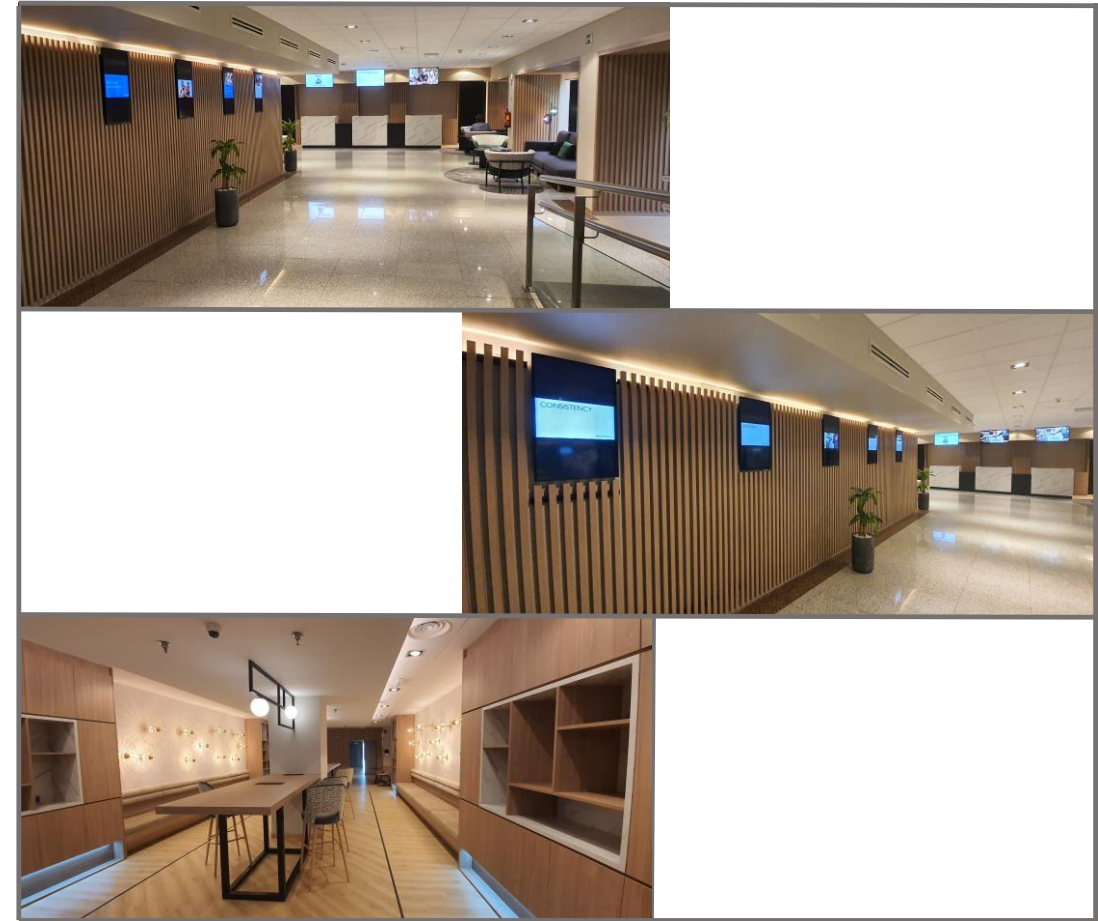
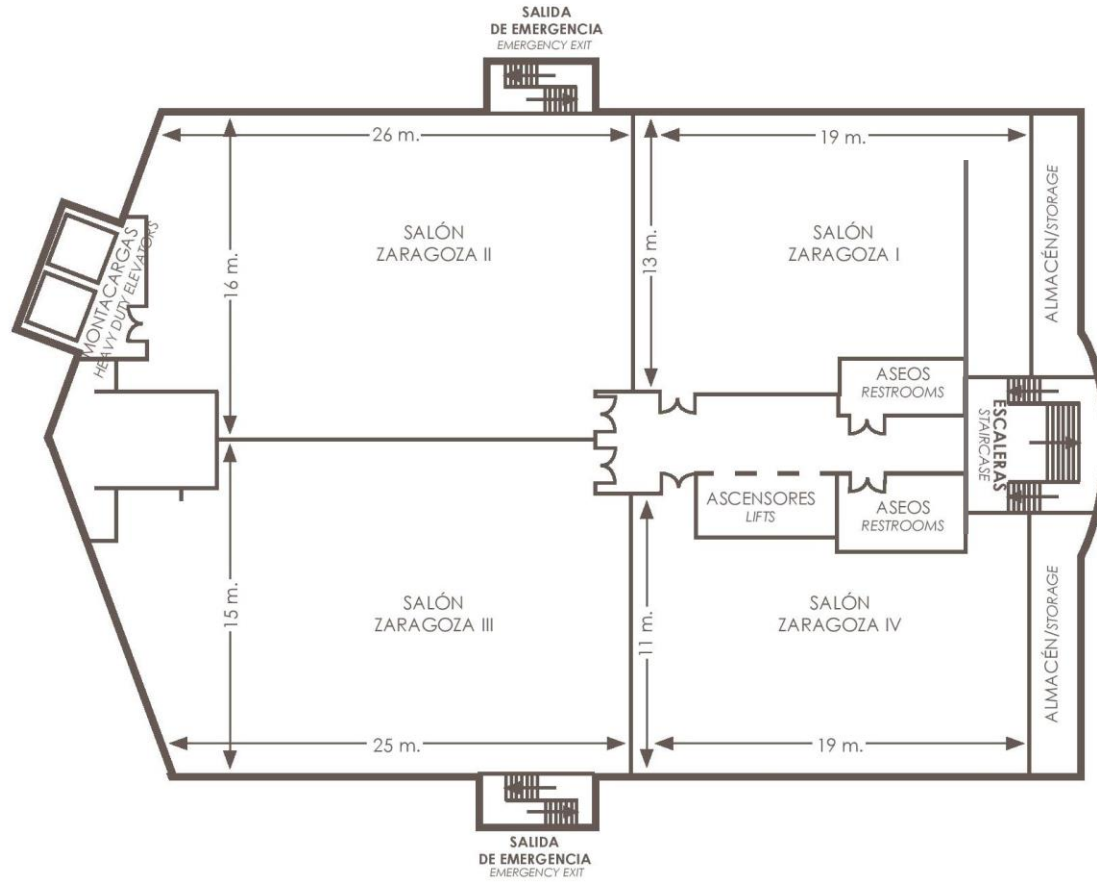

| SALONES           | PLANTA | M <sup>2</sup> | ALTURA | DIM. : LxA | U   | ESCUELA    | TEATRO  | IMPERIAL   | BANQ. | COCKTAIL | CABARET |
|-------------------|--------|----------------|--------|------------|-----|------------|---------|------------|-------|----------|---------|
| MEETING ROOMS     | FLOOR  | SQM            | HEIGHT | DIMENSIONS | U   | CLASS-ROOM | THEATRE | BOARD-ROOM | BANQ. | COCKTAIL | CABARET |
| ZARAGOZA I        | 4º     | 201,26         | 3      | 19x13      | 50  | 100        | 175     | 50         | 100   | 150      | 85      |
| ZARAGOZA II       | 4º     | 324,28         | 3      | 26X16      | 65  | 180        | 350     | 70         | 200   | 320      | 150     |
| ZARAGOZA III      | 4º     | 326,10         | 3      | 25X15      | 65  | 180        | 350     | 70         | 200   | 320      | 150     |
| ZARAGOZA IV       | 4º     | 188,84         | 3      | 19X11      | 50  | 100        | 175     | 50         | 100   | 150      | 85      |
| ZARAGOZA I + II   | 4º     | 525,54         | 3      | 42X15      | 120 | 350        | 600     | 110        | 360   | 600      | 260     |
| ZARAGOZA III + IV | 4º     | 714,38         | 3      | 44X14      | 120 | 350        | 600     | 110        | 360   | 600      | 260     |
| ZARAGOZA          | 4º     | 1.239,92       | 3      | 42X29      | -   | -          | -       | -          | 700   | 1000     | -       |